

Appendix 2: The boundaries of the proposed RIGS 2020 (as endorsed by the Rotherham Local Geological Sites Panel)

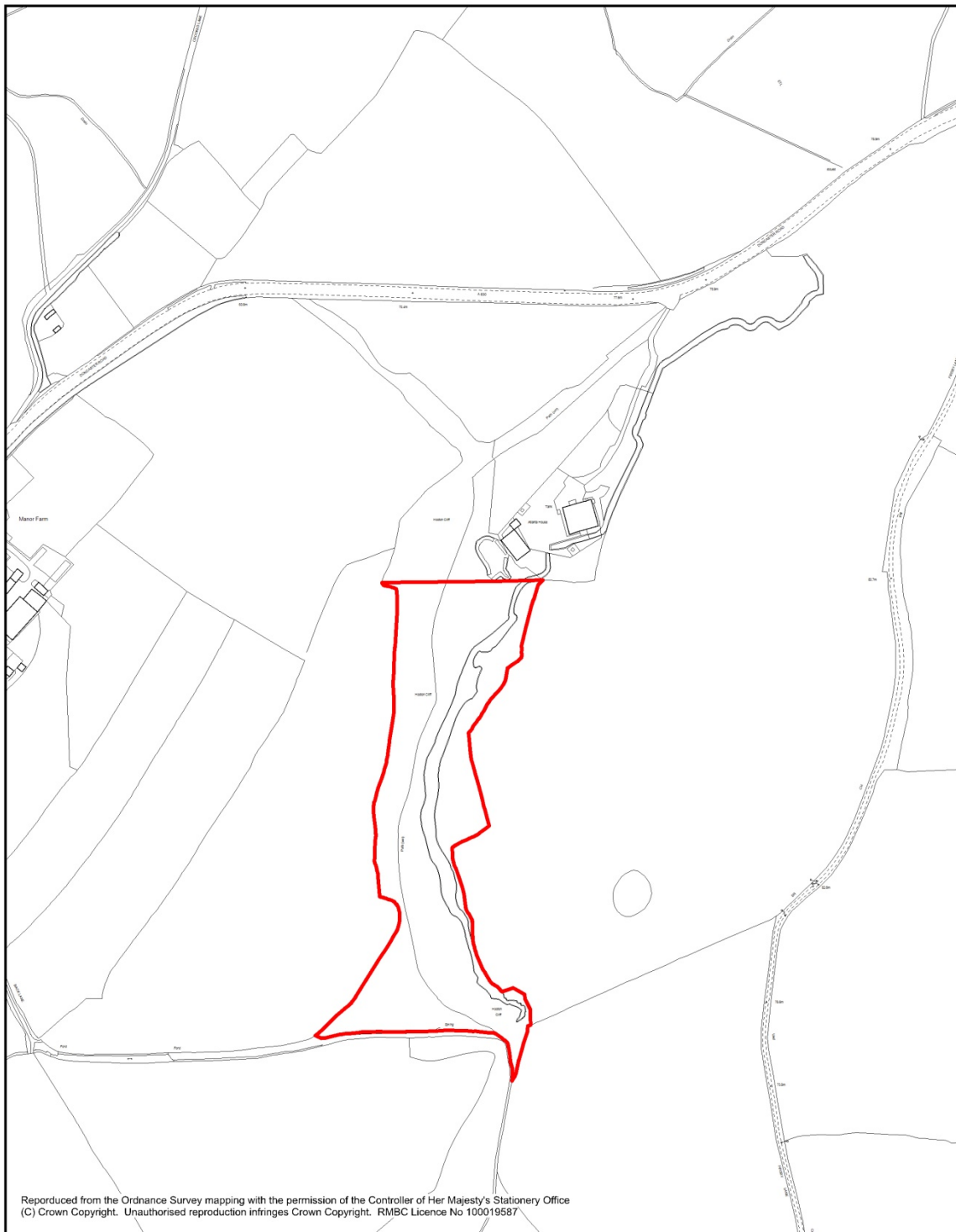

Reference R8 - Area 4.182ha

 Rigs Boundary

Scale NTS Date 2019

**Hooton Cliff
Hooton Roberts**

RMBC
Planning Regeneration and Environment
Riverside House
Main Street
Rotherham
S60 1AE

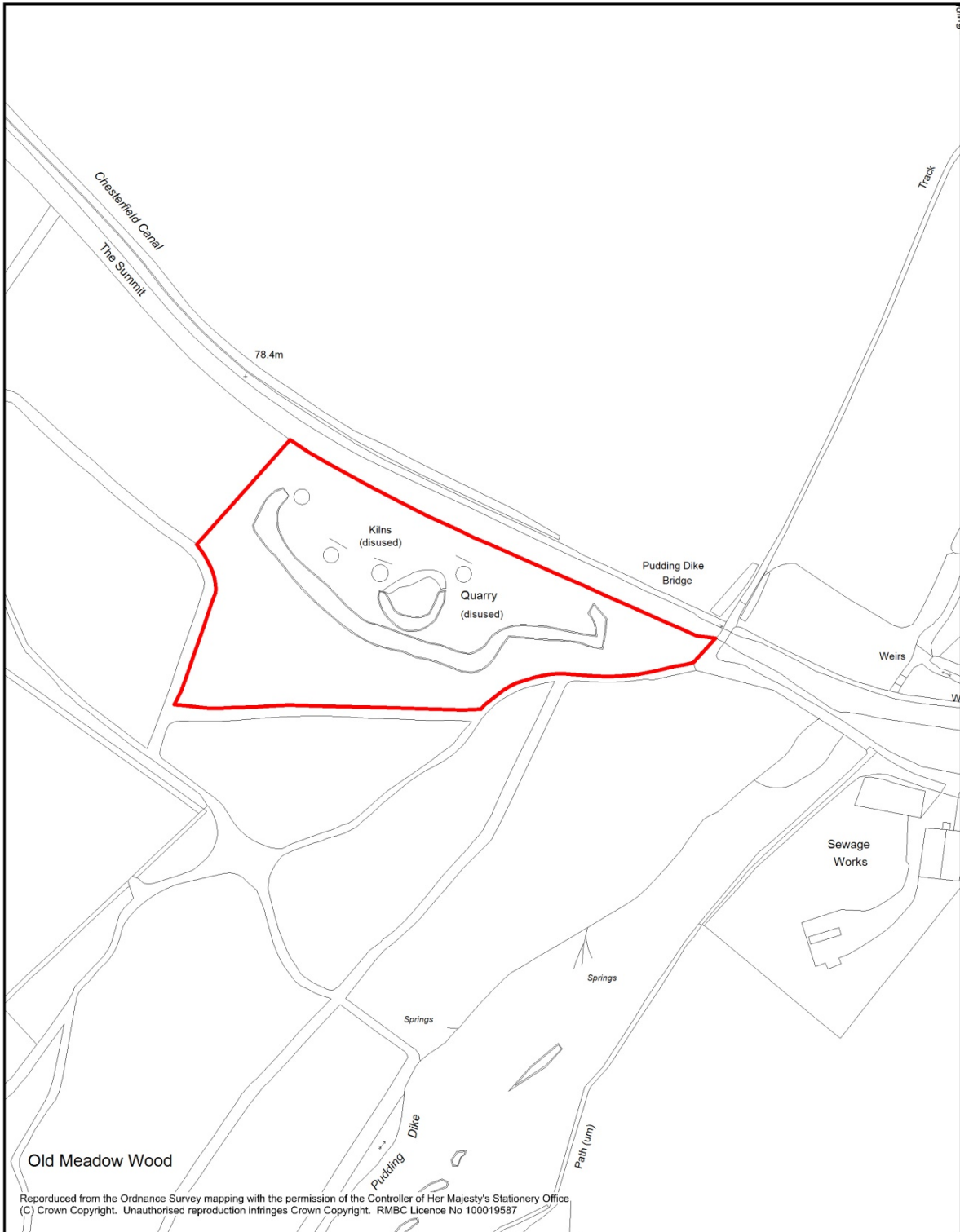

Reproduced from the Ordnance Survey mapping with the permission of the Controller of Her Majesty's Stationery Office. (C) Crown Copyright. Unauthorised reproduction infringes Crown Copyright. RMBC Licence No 100019587

Reference R78 - Area 1.451ha

 Rigs Boundary

Scale NTS Date 2019

Quarry, Hawks Wood Thorpe Salvin

RMBC
Planning Regeneration and Environment
Riverside House
Main Street
Rotherham
S60 1AE

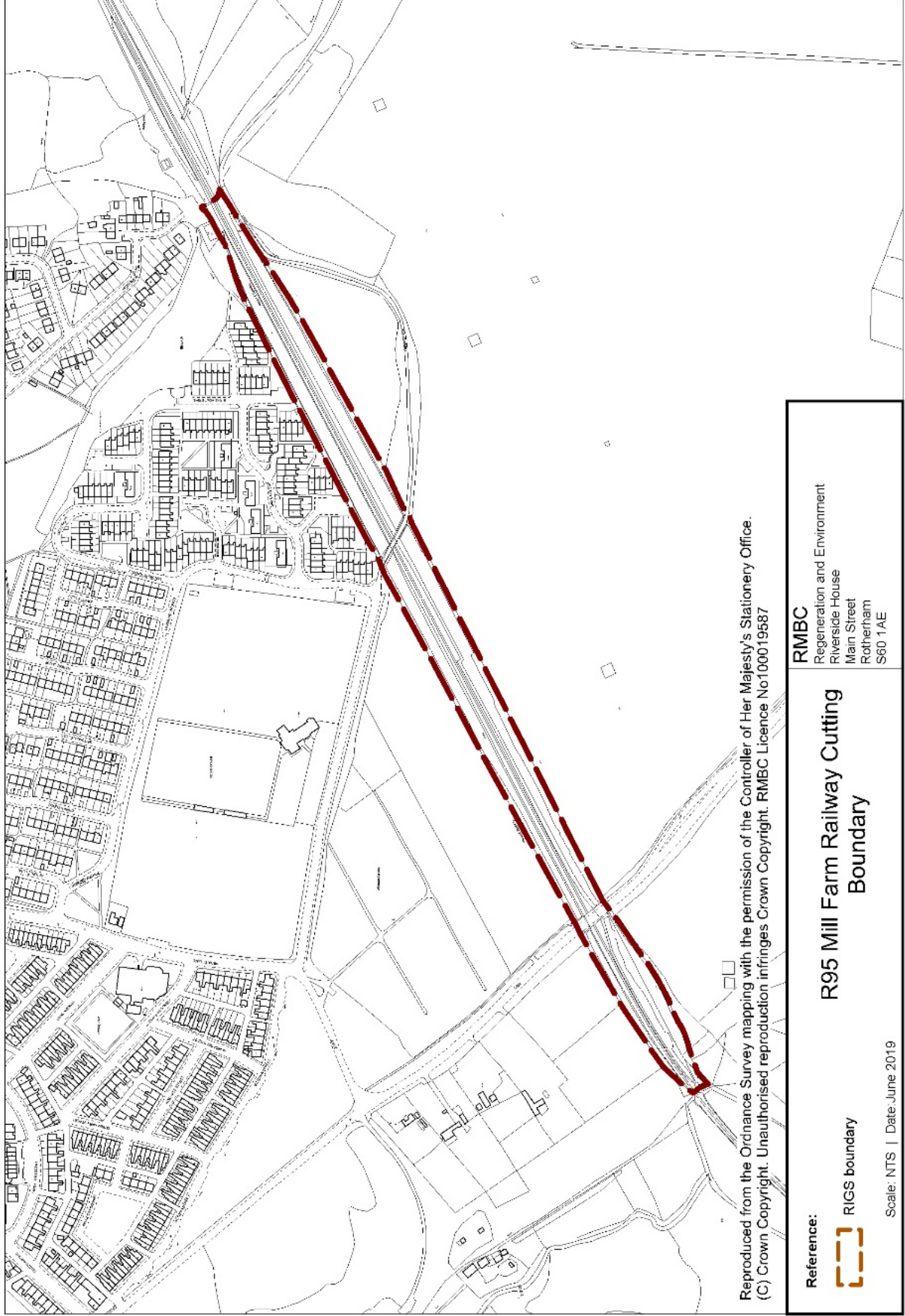

Reproduced from the Ordnance Survey mapping with the permission of the Controller of Her Majesty's Stationary Office.
 (C) Crown Copyright. Unauthorised reproduction infringes Crown Copyright. RMBC Licence No100019587

Reference:



RIGS boundary

Scale: NTS | Date: June 2019

RMBC

Regeneration and Environment
 Riverside House
 Main Street
 Rotherham
 S60 1AE

**R95 Mill Farm Railway Cutting
 Boundary**