

# Town Centre Public Ream Improvements

## Phase Two - Effingham Street (Upper section) Detailed Masterplan

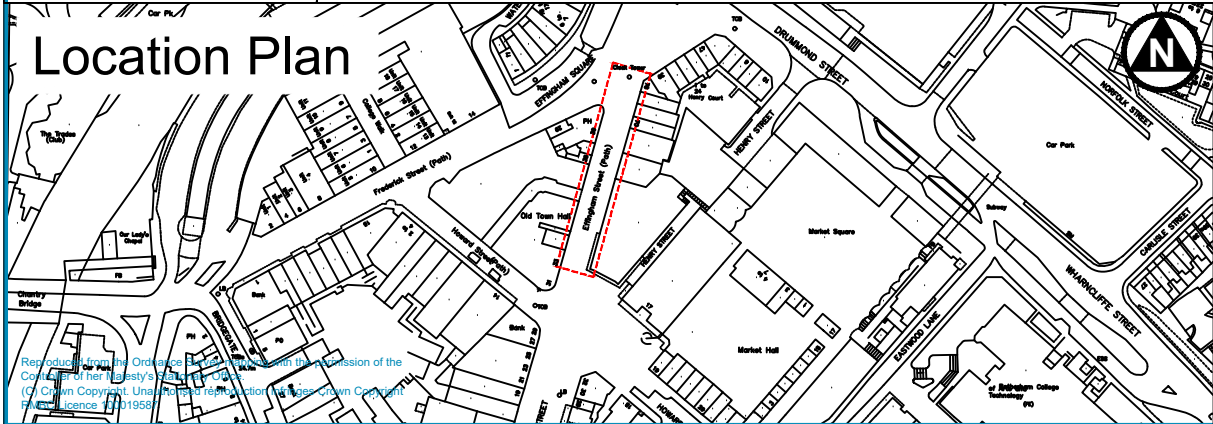
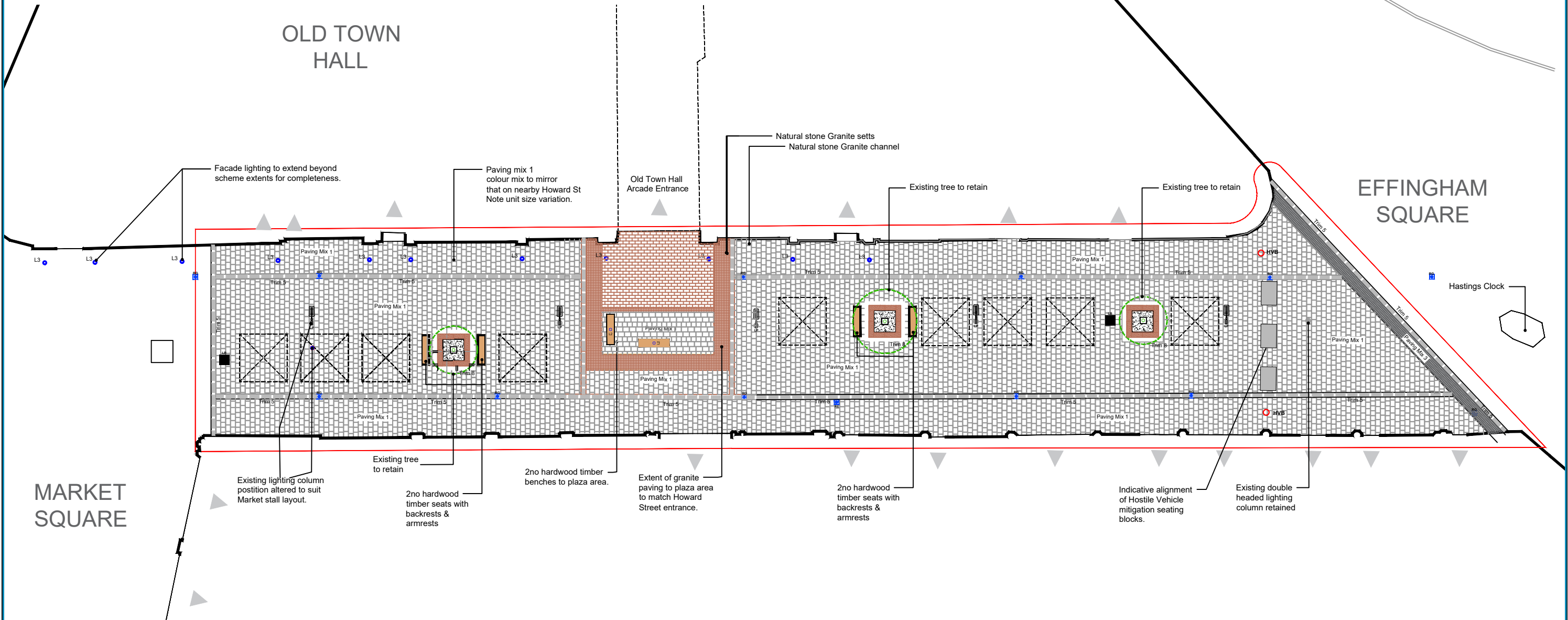

### Key to Features

- Natural Stone Paving**
- Proposed Marshalls Elara Granite sets. Mix of 300x200x75 / 300x150x75.
  - Proposed Marshalls Elara Granite sets. 100x100x75.
- Concrete Paving**
- Paving Mix 1- Pedestrian Zone. Proposed Marshalls Modal concrete paving. 200x300x40 / 300x300x40 (Dual Paver Pattern). 33% Light Granite, 33% Light Cream Granite, 33% Oatmeal Granite. Textured Finish.
  - Paving Mix 3 - Transition Band. Proposed Marshalls Modal concrete paving. 100x100x40. 100% Mid Grey Granite. Textured Finish.

- Edging**
- Concrete Paving Trim 8 to Tree surrounds. Proposed Marshalls Modal concrete paving. 300x100x40. Slatier course. Oatmeal. Textured Finish.
  - Concrete Paving (corner pieces). Proposed Marshalls Modal concrete paving. 300x300x40 including cut out for uplighters. Oatmeal. Textured Finish.
  - Paving Trim 5. Proposed Marshalls Modal concrete paving. 600x300x40. Slatier course. Oatmeal Granite. Textured Finish.
  - Proposed natural stone edging to tree pits. Marshalls Elara Granite kerbs. 300mm wide as tree surrounds - refer to tree pit detail.

- Street Furniture**
- Proposed hardwood timber bench. Bronxap Desford I Bench (or similar & approved). 1920x480x40mm. FSC certified timber. Galvanised mild steel base with powder-coated finish to RAL 7024. Surface-mounted.
  - Proposed hardwood timber seat. Bronxap Desford IV Seat (or similar & approved) with backrests and armrests. 1920x480x440mm. FSC certified timber. Galvanised mild steel base with powder-coated finish to RAL 7024. Surface-mounted.
  - Proposed tree grille. Proprietary Galvanised steel recessed tree grille with recessed resin infill panels to match Howard Street (or similar & approved). 1400x1400mm.
  - Existing litter bin to be relocated (or replaced) to position illustrated.
  - Hostile vehicle seating block (shallow mounted) location subject to utilities, trial holes and detailed specialist design required.
  - Removable hostile vehicle bollard array (shallow mounted) location subject to utilities, trial holes and detailed specialist design required.

- Lighting**
- Proposed uplighter to trees. LED recessed uplighter with symmetrical beam. Static. Integral driver. Flush with surrounding paving. Ability to outline post-installation. Pedestrian and cyclist loading capability. Include anti-slip coating. Allow for sealable junction box.
  - Proposed under-seat marker lighting. Four-way floor grazing LED recessed marker light. Static. 3000k. Black body colour. Integral driver. Allow for sealable junction box.
  - Proposed facade uplighter. Canon 30 - LED recessed circular in ground up-lighter, 240v, 12 degree beam with honeycomb louver, warm white LED, 30w. As supplied by Ark Lighting Ltd. quote ref 505252. Allow for sealable junction box.
  - Proposed street lights. Orientation of luminaires as per drawing. 6m Fabrikat Ltd Conical tapered lighting column with 4000k side entry mounted highway diamond 44 LED 700ma FO lens CLD enabled mounted at 0 deg tilt by ASD Lighting. Powder-coated to RAL 7024. subject to final lighting engineer confirmation.
- Planting**
- Existing trees to be retained.

- Miscellaneous**
- Site extents.
  - Entry points to buildings.
  - Suggested market stall locations - in-situ anchor points to be installed.
  - Drainage**
    - Proposed road gully to replace existing. 310x380mm size to match existing.



Strategic Director:  
Andrew Bramidge MA Urban Regen

Rotherham Metropolitan Borough Council  
Regeneration & Environment  
Riverside House, Main Street,  
Rotherham S60 1AE

Client:

- C Plaza area reduced to match Howard Street.
- B Street lighting relocated to exg positions.
- A Catenary lighting omitted from scheme.

Rev. Description

Title Rotherham Town Centre Public Realm Improvements  
Effingham Street - Upper Section  
Masterplan

Dwg. No. L5034\_101

Rev. C

Scales (if A3) 1:250

Drawn MF

Date 17/02/2025

Chd. by SHa