

- KEY**
- PROPOSED CARRIAGEWAY WIDENING
  - PROPOSED CARRIAGEWAY RESURFACING
  - PROPOSED CELLULAR CONSTRUCTION MAINTENANCE HARDSTANDING
  - STREET LIGHTING COLUMN - PROPOSED COLUMN, RELOCATED COLUMN OR REPLACED LUMINAIRE
  - PROPOSED TRAFFIC SIGNAL POLE

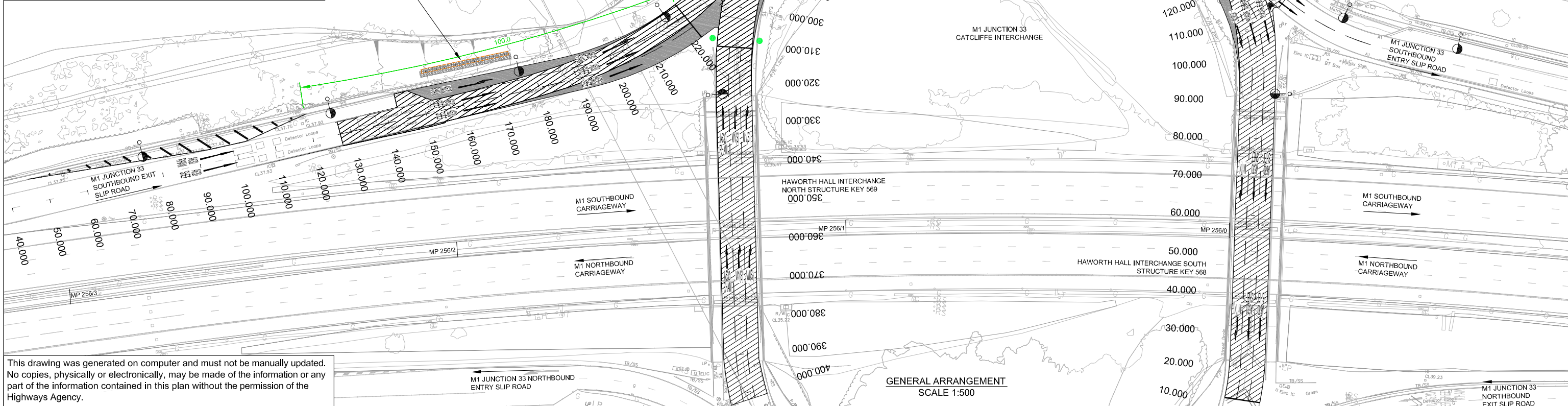

This drawing was generated on computer and must not be manually updated. No copies, physically or electronically, may be made of the information or any part of the information contained in this plan without the permission of the Highways Agency.

Iss	Amendment	By	Chkd.	Appd.	Date
3	Revised layout	CMC	TK	JC	18.07.13
2	Revised circulatory carriageway layout	CMC	TK	JC	5.07.13

Client  
**HIGHWAYS AGENCY**

Project  
**M1 Junction 33 Southbound Exit Slip Road Widening**

Issued only for purpose Indicated

**DRAFT**

Title  
**M1 Junction 33 Pinch Point Scheme General Arrangement**

Drawn CMC	Date 03.06.13	Checked TK	Date 13.06.13	Approved JC	Date 13.06.13
--------------	------------------	---------------	------------------	----------------	------------------

**mouchel**  
building great relationships

St. Johns House, Queen Street  
Manchester, M2 5JB  
Tel: 0161 832 4542  
Fax: 0161 835 2038

Scale  
**AS SHOWN AT A1**

Job No.  
**1043388**

MCL Drawing No.  
**1043388/132/100/001**

Issue:  
**3**

Sheet No.  
**Sheet 1 of 1**